

Product Code	Description
JC273-2-W	10AX 250V 3 Gang 2 Way Switch



JC273-2-W-LWH



Product back view

## Technical Specification

- Rated Voltage: 250VAC, 50/60Hz
- Rated Current: 10AX
- Recommended wire size:  
1.5mm<sup>2</sup> ~ 2.5mm<sup>2</sup>
- Isolating Gap Contact: 3mm nominal
- Contact Material: Silver-Nickel Alloy
- Operating Temperature:  
-5°C to +40°C
- IP Rating: IP4X
- No. of operations:  
40,000 at 10 Amp.
- Fix Center: 60.3mm
- Fix Screws:  
M3.5 x 0.6 x 25mm±

## With Lavina '95 Frame: JC1401

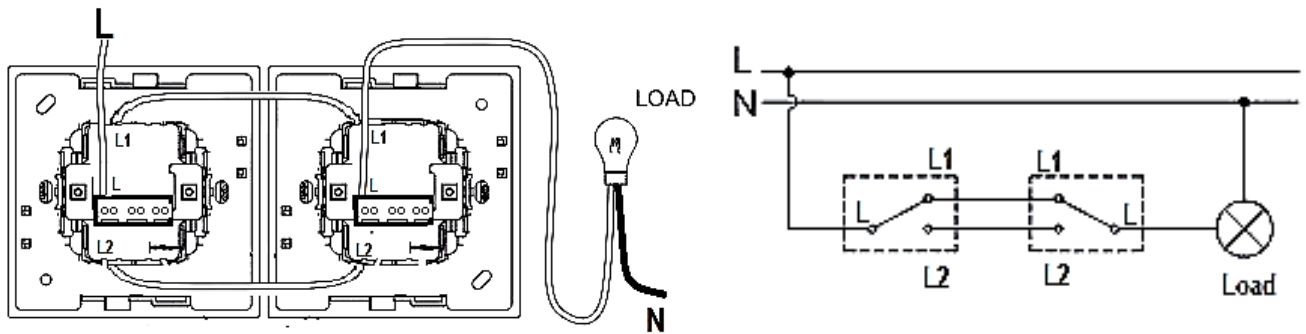

- Dimensions: 95x95x10mm (WxHxD)
- Mounting box: >40mm depth
  - J1040, flush mounting, plastic  
74.5 x 74.5 x 42mm (W x H x D)
  - M1050, flush mounting, metal  
75.5 x 64 x 50mm (W x H x D)
- Comply to Standards:
  - IEC 60669-1
  - BS EN 60669
  - GB/T 16915.1

## Typical Two-way Switch Connection:

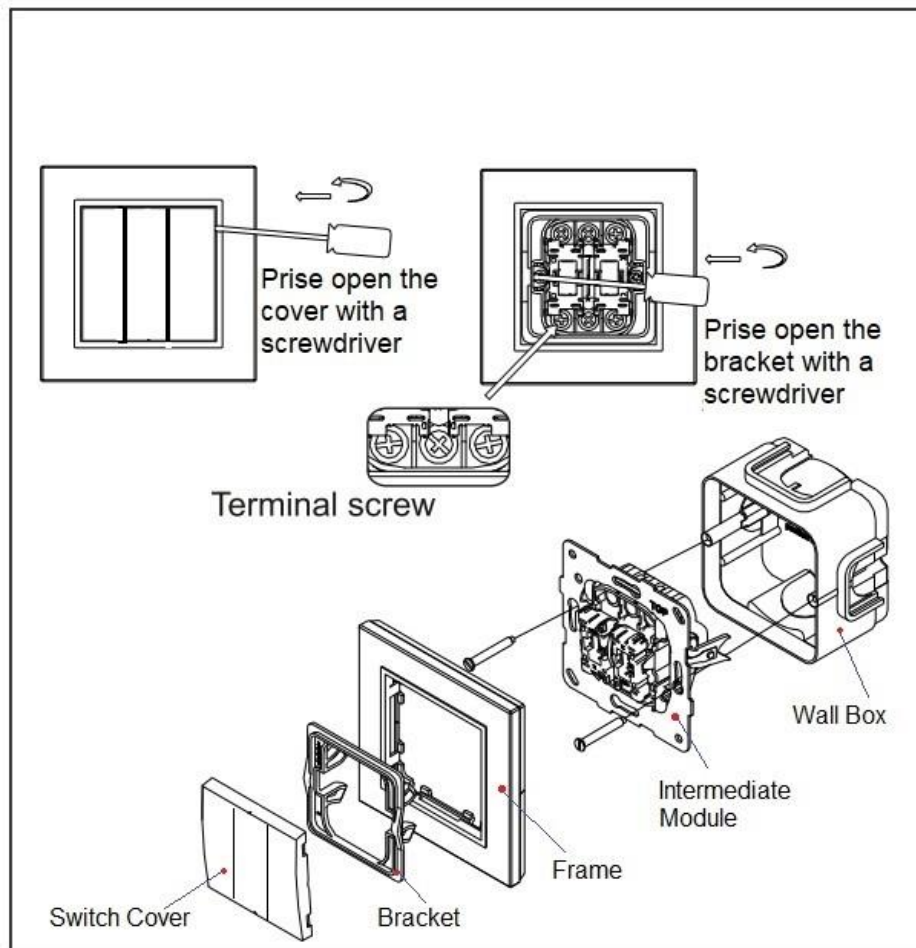

## Mounting Diagram (for reference)

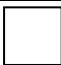

Product Code	Colour
JC273-2-W-LWH	 Matt White
JC273-2-W-LBL	 Matt Black
For other colours, please contact T&J Sales representative	